

RESOLUTION NO. 2018 –09

2018 SIOUX COUNTY ZONING MAP

WHEREAS, acting pursuant to Iowa Code Section 335.4, Sioux County previously adopted a zoning map in 2014;

WHEREAS, Iowa Code Section 335.7 further provides that the Board of Supervisors may repeal previously adopted zoning regulations, restrictions, and boundaries at any time,

WHEREAS, Sioux County desires to repeal and replace the county zoning map adopted as part of the Zoning Ordinance previously adopted by the Board of Supervisors in 2014;

WHEREAS, the Board, having set a public hearing on the proposed replacement of the 2014 zoning map; having timely published notice of the time and place of the public hearing on the proposed replacement of the 2014 zoning map; and after soliciting and considering public comment and input on the proposed replacement of the 2014 zoning map, is ready to finally act on such proposal.

NOW, THEREFORE, BE IT RESOLVED that the Sioux County Board of Supervisors hereby approves the replacement of the current zoning map which is incorporated herein by this reference. A copy of the amended 2014 county zoning map is available for public review at the office of the Sioux County Zoning Administrator/ Courthouse/ Orange City/Iowa.

PASSED AND APPROVED this 20th day of March, 2018



Mark Sybesma
Chairman, Board of Supervisors

ATTEST:



Ryan Dokter, Sioux County Auditor

SIoux COUNTY ZONING MAP 2018

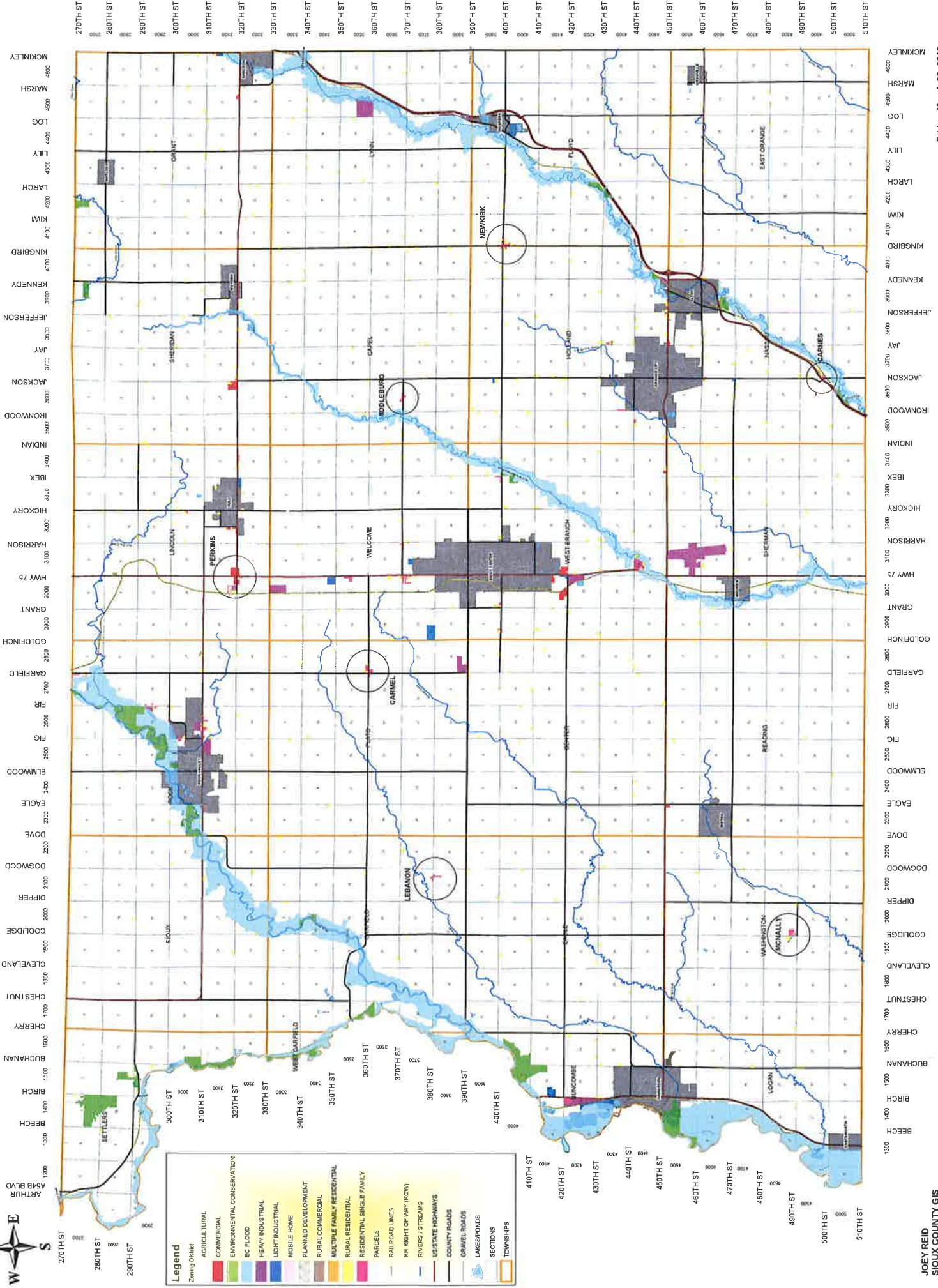

Legend

Zoning District

- AGRICULTURAL
- COMMERCIAL
- ENVIRONMENTAL CONSERVATION
- EC FLOOD
- HEAVY INDUSTRIAL
- LIGHT INDUSTRIAL
- MOBILE HOME
- PLANNED DEVELOPMENT
- RURAL COMMERCIAL
- MULTIPLE FAMILY RESIDENTIAL
- RURAL RESIDENTIAL
- RESIDENTIAL SINGLE FAMILY
- PARCELS
- RAILROAD LINES
- RR RIGHT OF WAY (ROW)
- RIVERS / STREAMS
- US STATE HIGHWAYS
- COUNTY ROADS
- GRAVEL ROADS
- LAKES/PONDS
- SECTIONS
- TOWNSHIPS